

Compact shape and silent movement, made of strong die-cast aluminum and UV resistant covers

Simplified adjustment of the on-board mechanical stops, mechanical limit switches as standard

Even more compact size: installation height just 5 cm from ground level

## Designed for PVC, WOOD OR ALUMINIUM leaves (swing gates)

- + 120mm width only, ideal for narrow small posts
- + Intuitive manual release with SUB remotes
- + Slide arm accessory available for reduced openings
- + Back-up battery optional on board

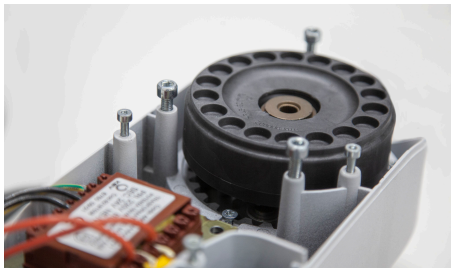

### KITS & MODELS

CODE	DESCRIPTION
<b>KREP2224</b>	Kit for double swing gates with maximum length 2,3 m or weight 250 kg per leaf, 24 Vdc motor, With control unit CT10224. Residential use
<b>REP2224</b>	For swing gates with maximum length 2,3 m or weight 250 kg per leaf, 24 Vdc motor. With control unit CT10224. Residential use (Master motor)
<b>REP2224S</b>	For swing gates with maximum length 2,3 m or weight 250 kg per leaf, 24 Vdc motor. Without control unit. Residential use (Slave motor)

### DIMENSIONS

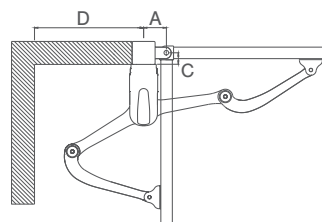
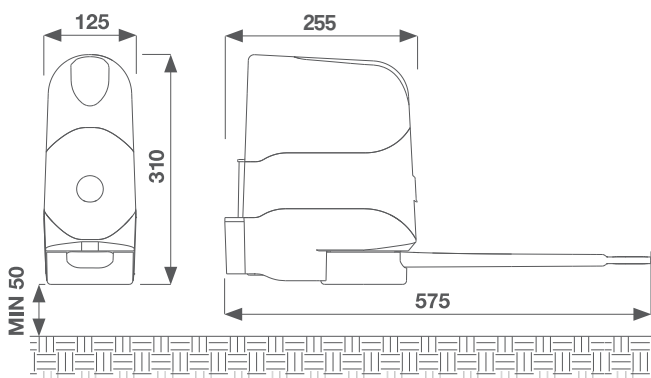

<b>A min</b>	100
<b>C max</b>	200
<b>D min</b>	450

## TECHNICAL DATA

		REP2224	REP2224S
<b>MECHANICAL DATA</b>			
torque	Nm	120	120
cycles/hour*		30	30
opening time at 90°	sec	14-20	14-20
<b>ELECTRICAL DATA</b>			
control board		14A	-
power	Vac	230	-
	Vdc	-	24
consumption	A	0,65	2
absorbed power	W	115	50
<b>GENERIC DATA</b>			
protection degree	IP	44	44
dimensions (L - D - H)	mm	125 - 255 - 310	125 - 255 - 310
weight	kg cad	13,5	10
working temperature	°C	-20 + 55	-20 + 55
leaves maximum weight	kg	250	250

\* The cycles now indicated are intended with a non-paneled door at an ambient temperature of 20 °C.

## LIMIT USE

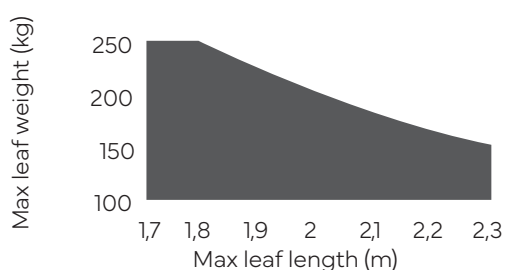

Gate shape and height and weather conditions can considerably reduce the values shown above, in the graph.

## ACCESSORIES



**ELC-C** 12 V horizontal electric lock. Up to 2000 kg

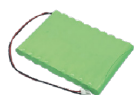

**KBPN** Kit of 1.3 Ah lead battery and battery charger



**KC** Unlock key cylinder



**REV1** Slide arm accessory



**REV2** Slide arm accessory for reduced openings



**SUB remotes** Water and dust resistant 433MHz transmitters, rolling code



**SPLIT24V** Low voltage 24V in an enclosure



**KSOLEAU** Solar kit with batteries, recharge unit in enclosure and mounting brackets



**EGKTR1** Wireless RGB lighting keypad



**KUBEU** Bluetooth Low Energy module with two 5A relay outputs



**KPLAY4R** Kit with 2x 4-channel 433 MHz transmitters, rolling code



**FT43** Pair of photocells for external use adjustable through 180



**FT43B** Pair of photocells for external use adjustable through 180, battery version



**FT33** Pair of photocells for external use, flush mounting



**RP25K** Reflective photocells